

P.O. Box 1099 Soquel, CA 95073 PH:831-475-0959 FAX:831-684-0224



Fax

To: Frank Murphy From: Joan

Fax: _____ Pages: 4

Phone: _____ Date: 4/3/03

Re: _____ CC: _____

- Urgent
- For Review
- Please Comment
- Please Reply
- Please Recycle

• Comments:

*Septic reports on 495 Quinary Estate
Re: Wendy Green*

Thankyou

Pete's Outflow Technicians

P.O. Box 1066

Soquel, CA 95073

Ph: (831) 475-0959

Fax: (831) 685-0224

Septic System Inspection Report

System 1

Property Address 495 Country Estate Terrace, Bonny Doon, California

Tank

Was The tank pumped? yes Date March 31, 2003

Approximate size of tank 1500 gallons

Type of tank: Redwood Concrete XX Fiberglass Other

Condition of tank and baffles Good condltion

Type and condition of lid Concrete lids, good condltion

Required repairs and comments _____

Leachfield

Does level of tank indicate drainfield failure No

Are there wetspots, or any other indication of drainfield failure No

Signature of Contractor _____

License Number 2109

Date March 31, 2003

Notice to Buyer: It is not practical to inspect the actual drainfields as they are buried in the ground. The above evaluation only measures the ability of the drainfield to handle the quantity of water/effluent it has been recently processing. It does not insure that it will not fail under a greater load. All drainfields will fail if they receive more water than can be absorbed into the ground immediately surrounding the field.

SEPTIC TANK PUMPING AND INSPECTION REPORT

PUMPER NAME: Pete's Outflow Technicians

INSPECTION DATE: March 31, 2003

JOB LOCATION: 495 Country Estate Terrace System 1

APN: 63-182-02

JOB CITY/AREA/CLOSEST CROSS STREET: Bonny Doon

OWNER: Walley Green ADDRESS: 495 Co. Estatae Terrace

REQUESTED BY: " ADDRESS: "

REASON FOR PUMPING/INSPECTION

MAINTENANCE HAULWAY SALE INSPECTION X SYSTEM FAILURE REPAIR OTHER

PROPERTY USE: HOME X OTHER OCCUPIED? YES X NO SLUDGE DISPOSAL LOCATION: SCWTP

SEPTIC TANK: SIZE 1500 GALLONS PUMPED 1500 BOTH COMPARTMENTS PUMPED? Yes

TYPE: REDWOOD	CONCRETE	POLY	FIBERGLASS	OTHER
GOOD	FAIR	POOR	REPAIRS RECOMMENDED	REPAIRS COMPLETED/DATE
SEPTIC ELLS/TREES	X			
TANK TOP AND/OR LIDS	X			
SIDES/BOTTOM OF TANK	X			
BAFFLES	X			

OPERATIONAL LEVEL: HIGH LOW NORMAL X DATE LAST PUMPED:

LEACHING SYSTEM

PRESENT OR PAST HIGH LEVEL IN TANK YES NO X
 LIQUID FLOWBACK WHILE PUMPING? YES NO X
 SIGNS OF SURFACING EFFLUENT? YES NO X
 SEPARATE GREY WATER DISCHARGE? YES NO X
 OTHER SYSTEM COMPONENTS/NOTES: LOCATION: ONTO GROUND

SYSTEM LOCATION (SKETCH OR DESCRIBE, WITH MEASURED DIMENSIONS AND DIRECTION OF NORTH; INCLUDE ANY PERTINENT FEATURES SUCH AS PAVED AREAS, SURFACING EFFLUENT, CREEKS, LARGE TREES, ETC.)

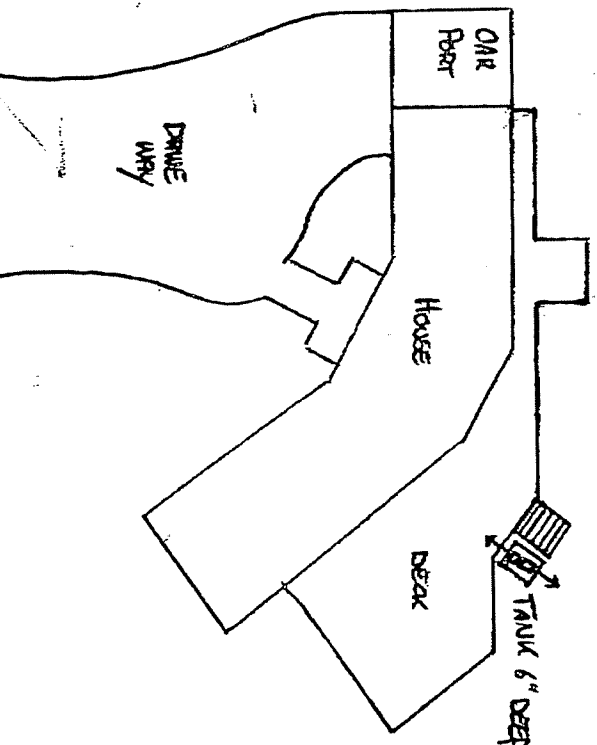

Pete's Outflow Technicians

P.O. Box 1066
Soquel, CA 95073
Ph: (831) 475-0959
Fax: (831) 685-0224

Septic System Inspection Report

System 2

Property Address 495 Country Estate Terrace, Bonny Doon, California

Tank

Was The tank pumped? Yes Date March 31, 2003

Approximate size of tank 1500 gallons

Type of tank: Redwood Concrete xx Fiberglass Other

Condition of tank and baffles Tank, baffle good. Back elbow good
front elbow poor

Type and condition of lid Concrete lids, good condition

Required repairs and comments Recommend repair front elbow

Leachfield

Does level of tank indicate drainfield failure No

Are there wetspots, or any other indication of drainfield failure No

Signature of Contractor 
License Number _____
Date _____

Notice to Buyer: It is not practical to inspect the actual drainfields as they are buried in the ground. The above evaluation only measures the ability of the drainfield to handle the quantity of water/effluent it has been recently processing. It does not insure that it will not fail under a greater load. All drainfields will fail if they receive more water than can be absorbed into the ground immediately surrounding the field.

SEPTIC TANK PUMPING AND INSPECTION REPORT

PUMPER NAME: Pete's Outflow Technicians

INSPECTION DATE: March 31, 2003

JOB LOCATION: 495 Country Estate Terrace

System 2

APN: 63-182-02

JOB CITY/AREA/CLOSEST CROSS STREET: Bonny Doon

OWNER: Walley Green

ADDRESS: 495 Co. Estate Terrace

REQUESTED BY: "

ADDRESS: "

REASON FOR PUMPING/INSPECTION

MAINTENANCE HAULAWAY SALE INSPECTION X SYSTEM FAILURE REPAIR OTHER SLUDGE DISPOSAL LOCATION: SCWTP

PROPERTY USE: HOME X OTHER OCCLUDED? YES X NO

SLUDGE DISPOSAL LOCATION: SCWTP

SEPTIC TANK: SIZE 1500 GALLONS PUMPED 1500 BOTH COMPARTMENTS PUMPED? Yes

TYPE: REDWOOD CONCRETE XX POLY FIBERGLASS OTHER

CONDITION OF TANK	GOOD	FAIR	POOR	REPAIRS RECOMMENDED	REPAIRS COMPLETED/DATE
SEPTIC BLS/TREES			back	front	XX
TANK TOP AND/OR LIDS	X				
SIDES/BOTTOM OF TANK	X				
BARFLES	X				

OPERATIONAL LEVEL: HIGH LOW NORMAL X DATE LAST PUMPED:

LEACHING SYSTEM

PRESENT OR PAST HIGH LEVEL IN TANK YES NO X
 LIQUID FLOWBACK WHILE PUMPING? YES NO X
 SIGNS OF SURFACING EFFLUENT? YES NO X
 SEPARATE GREYWATER DISCHARGE? YES NO X
 OTHER SYSTEM COMPONENTS/NOTES: LOCATION: ONTO GROUND

SYSTEM LOCATION (SKETCH OR DESCRIBE, WITH MEASURED DIMENSIONS AND DIRECTION OF NORTH; INCLUDE ANY PERTINENT FEATURES SUCH AS PAVED AREAS, SURFACING EFFLUENT, CREEKS, LARGE TREES, ETC.)

